



Like all FH Group® auto accessories, these custom car seat covers were designed with the utmost precision, created from the highest quality of materials, and produced with the intent of providing every driver with a tailored luxury car experience. With FH Group® you will always Take Pride In Your Ride™.

To register for the Custom Seat Cover Limited Warranty, go to <https://www.fhgroupauto.com/warranty/>



INSTALLATION MANUAL

CM5003-Jeep Wrangler JK 4DR 2008-2018

Rugged protection tenacious style. Choose your own adventure with custom-fitted seat covers by FH Group.

CM5003-REAR

Video instructions are available at
<https://www.fhgroupauto.com/product/seat-covers-jeep-wrangler-jk-2007-2018/>

Warning

- Machine wash cold, delicate cycle. Air dry only.
- Avoid sharp objects to protect covers from being scratched/damaged.
- We suggest wearing protective eyewear and gloves during installation.

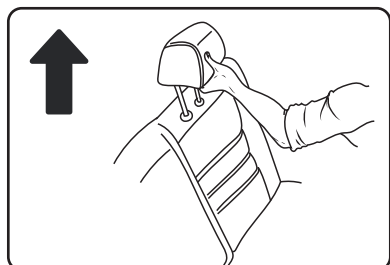
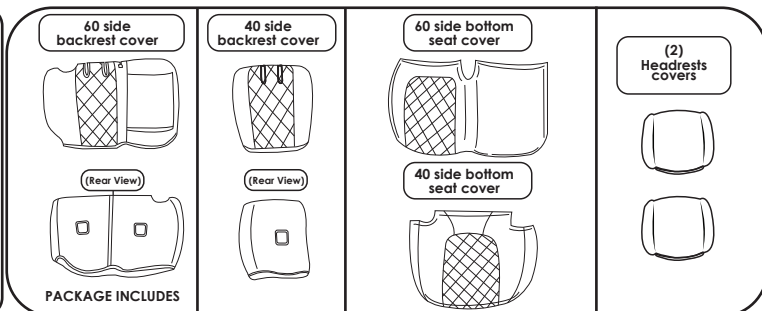

- 1 To start, remove the headrest by pushing the release button at the base of the headrest.

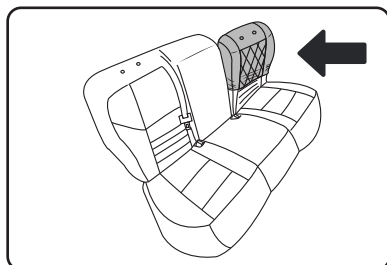

- 2 Pull the 40 side bench seat forward and slide the left backrest cover down.

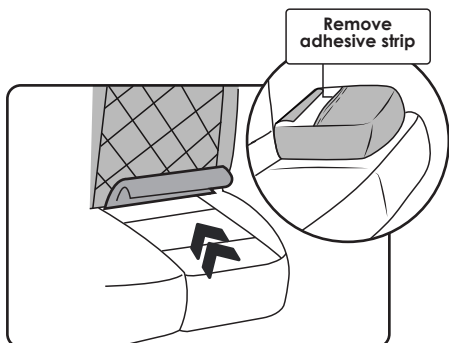

- 3 Locate the fabric flap at the bottom of the 40 side backrest cover and push it through the seat's crevice. Then, attach it to back side of the seat cover.

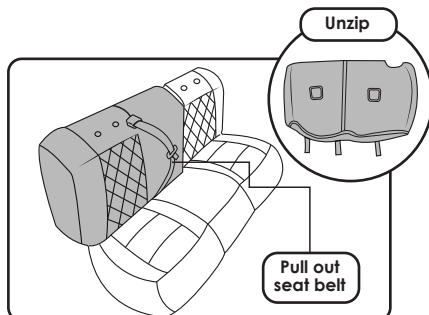

- 4 Unzip the 60 side backrest cover. Pull the right bench backrest forward and slide the cover down. Make sure you pull out your vehicle's seat belt before you zip up the backrest cover.

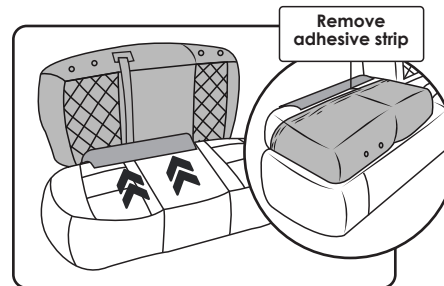

- 5 Insert the fabric flap through the seat crevice and attach it to the back of the backrest cover. Following the same steps as you did with the 40 side cover.

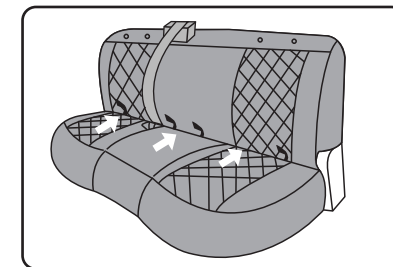

- 6 Place the bottom seat cover on the bench seat cushion and push the buckle straps through the center crevice of your car seat.

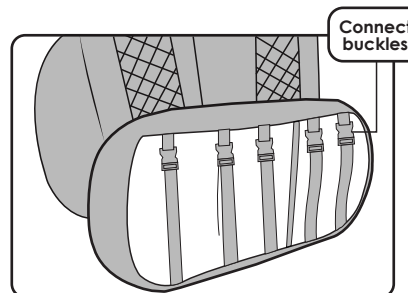

- 7 Connect together the front and back buckle straps underneath the seat as shown in the image.

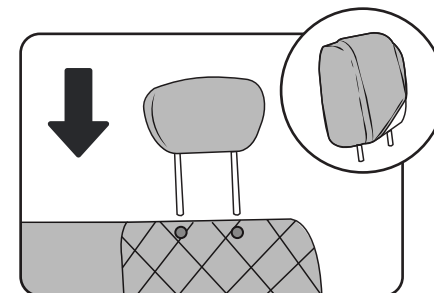

- 8 Slip on the headrest cover and reattach the headrests. TIP: Starting from either side of the headrest and sliding the cover sideways will help you achieve a secure fit.

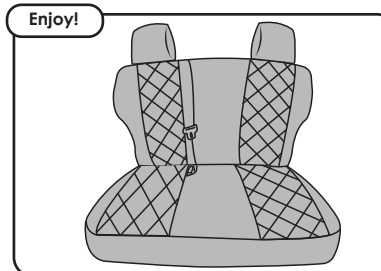

- 9 Adjust accordingly, smooth out your custom fit seat covers and enjoy!