

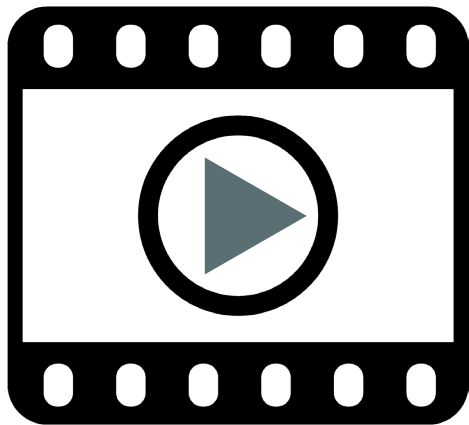

# INSTALLATION IS THE KEY



watch installation videos at  
<https://www.fhgroupauto.com/installation/>

For more info, call 1-800-928-5518  
or email us at [info@fhgroupauto.com](mailto:info@fhgroupauto.com)



# NEED HELP?

**Have Questions About Your Order?**  
FH Group® representatives are ready to help!

**Watch Our Installation Videos**  
Watching our instructional videos FIRST will save time and answer most of your questions. With some patience and proper installation, you can enjoy beautifully fitted covers before you know it (turn over to learn where you can watch our videos).

**Toll Free**  
**1-800-928-5518**  
**[info@fhgroupauto.com](mailto:info@fhgroupauto.com)**

# Installation Manual

## FB202

Video instructions are available at <https://www.fhgroupauto.com/installation>

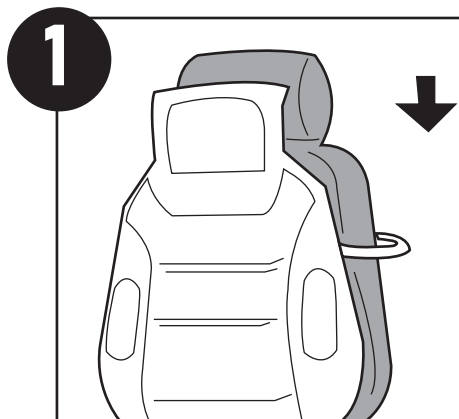

1  
Locate the elastic band on the backrest portion of the cover. Stretch the band over and behind your seatback, gently pulling the cover down so it aligns with the seatback.

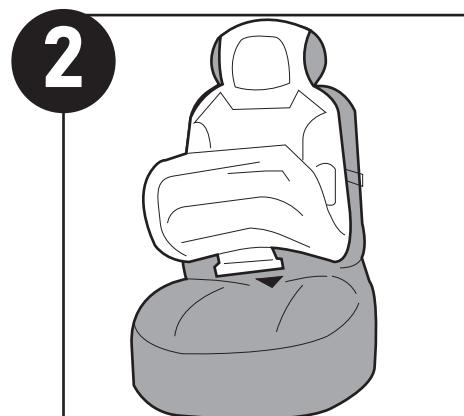

2  
Lift up the cover's lower portion and locate the cover's foam bar attachment at the back. Push the attachment deep into your seat's center crevice.

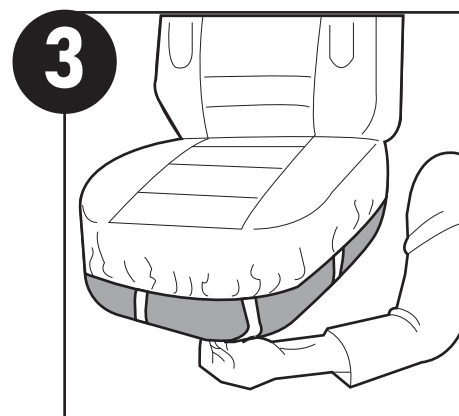

3  
Fit the cover's lower portion over the seat bottom. For an extra secure fit, you can hook the cushion's bottom straps to any available bars/hardware underneath the seat. You can also tuck the straps and excess fabric underneath the seat cushion.

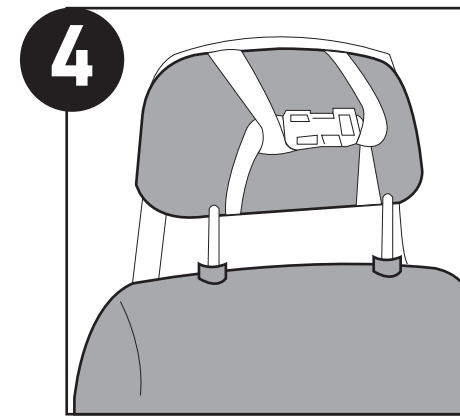

4  
Undo the buckle located behind the cover's headrest portion. Drape the cover's top straps over and behind the headrest: secure by looping the straps through the back buckle and snapping the buckle closed.