

Installation Manual

FB118102

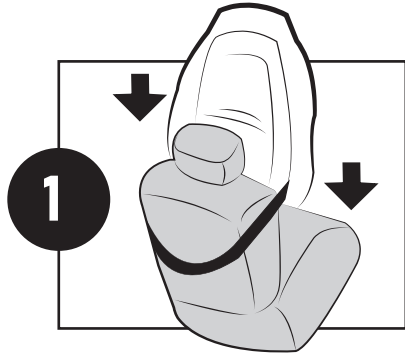

1 Pull the car seat cover straps over your bucket seat.

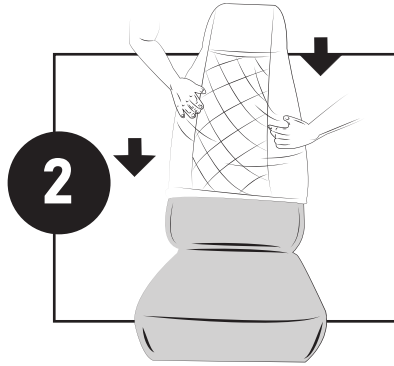

2 Slide the top portion of the cover over the seat.

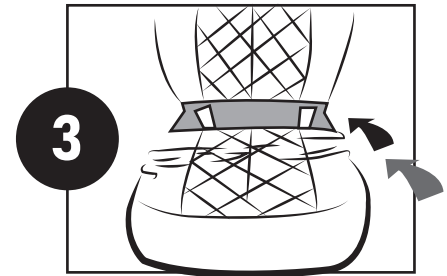

3 Slide the bottom cover onto the car seat.

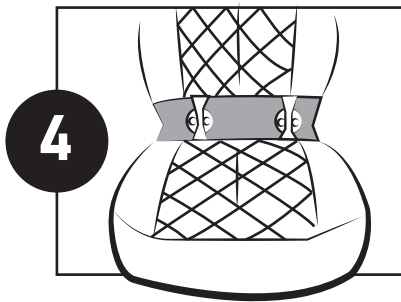

4 Loop the butterfly discs to the straps of the upper and bottom portion of your cover. Your seat covers should look like this.

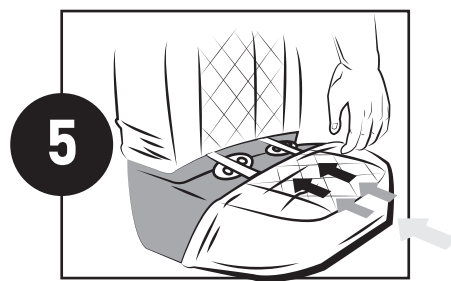

5 Push the butterfly discs through the center services of the seat.

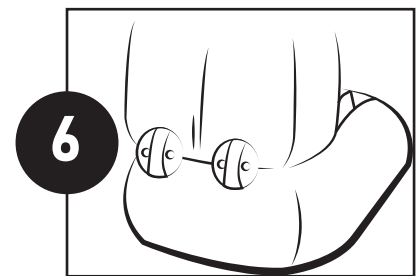

6 The back of your seat should look like this.

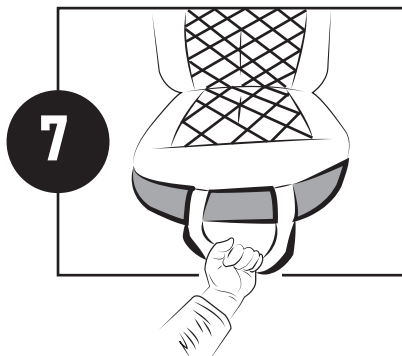

7 For a more secure fit, use the hooks included in the bag to attach the front strap underneath the seat. WE SUGGEST WEARING PROTECTIVE EYEWEAR AND GLOVES FOR THIS STEP! You may have to look underneath or feel around for a secure place to hook the strap.

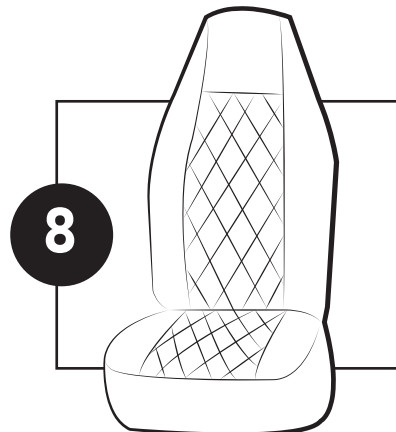

8 Your front car seat should look like this.